

8

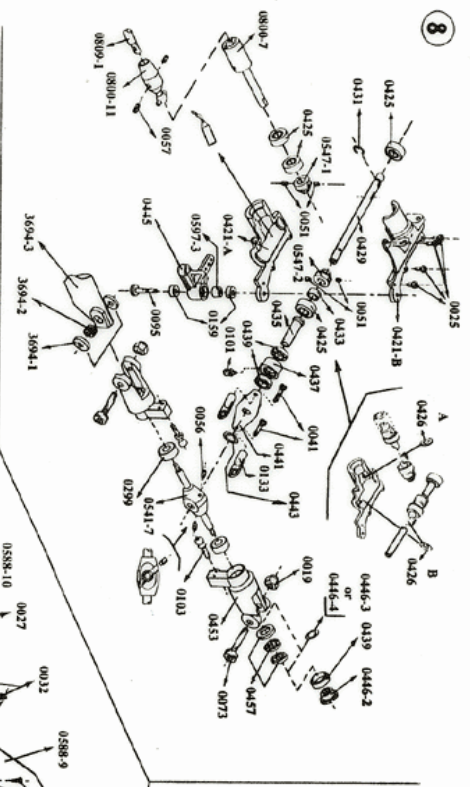

NOTE: The fuselage must be assembled in the correct order. Refer to the assembly manual for details.

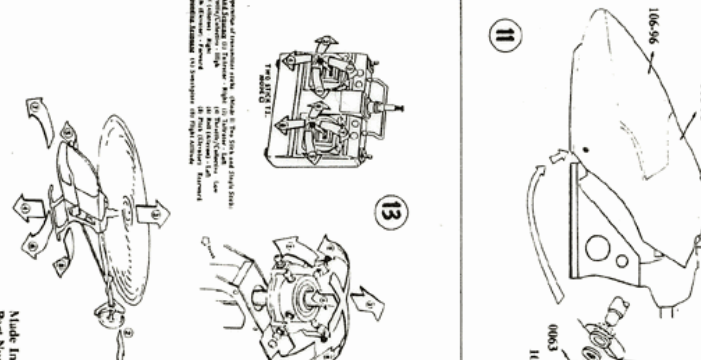
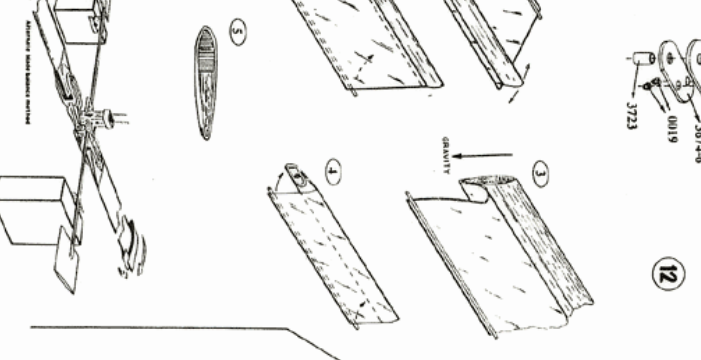
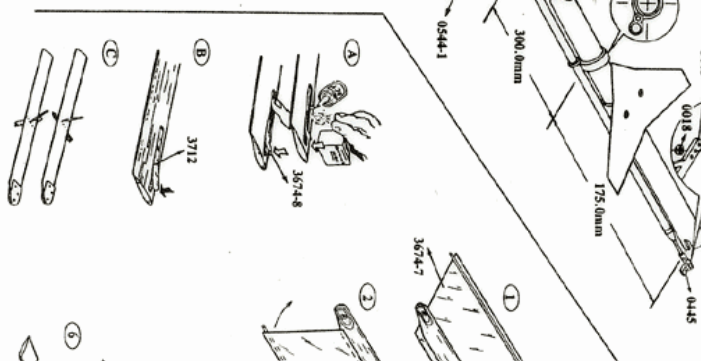
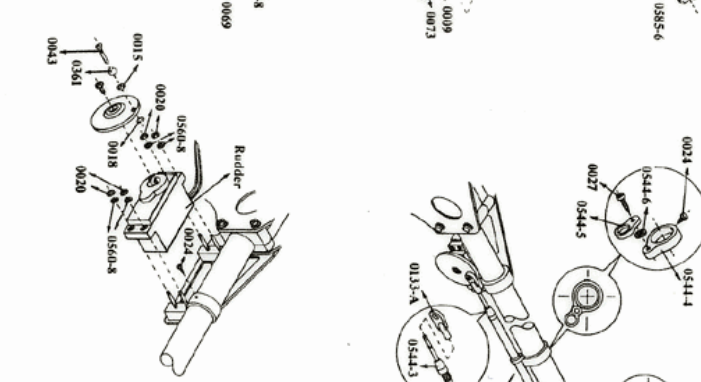
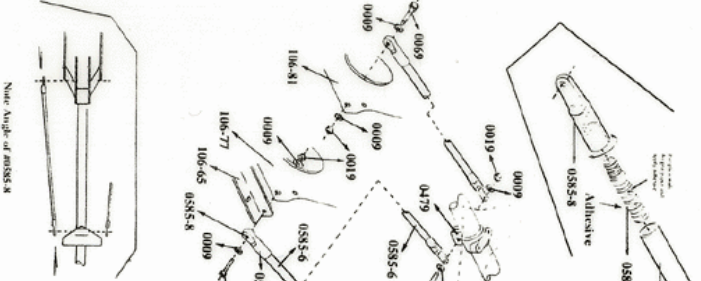
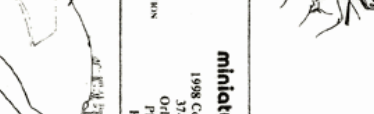
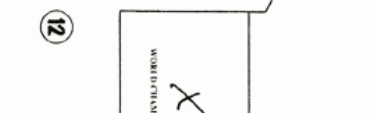
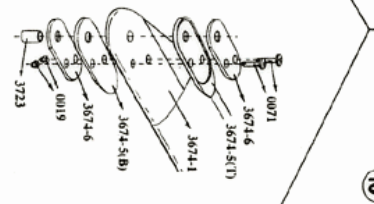
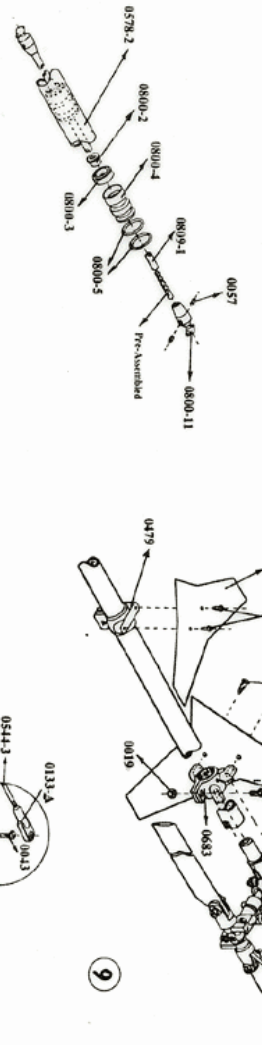

X1-Pro II
miniature aircraft usa

1998 Copyright By Schoenhardt
3723 Silver Star Road
Orlando, Florida 32808
Phone: 407-292-4267
FAX: 407-292-4296

NOTE: THE FUSelage MUST BE ASSEMBLED IN THE CORRECT ORDER. REFER TO THE ASSEMBLY MANUAL FOR DETAILS.

NOTE: THE WING MUST BE ASSEMBLED IN THE CORRECT ORDER. REFER TO THE ASSEMBLY MANUAL FOR DETAILS.

NOTE: THE LANDING GEAR MUST BE ASSEMBLED IN THE CORRECT ORDER. REFER TO THE ASSEMBLY MANUAL FOR DETAILS.

NOTE: THE CONTROL SURFACES MUST BE ASSEMBLED IN THE CORRECT ORDER. REFER TO THE ASSEMBLY MANUAL FOR DETAILS.

NOTE: THE PROPPELLER MUST BE ASSEMBLED IN THE CORRECT ORDER. REFER TO THE ASSEMBLY MANUAL FOR DETAILS.

NOTE: THE MOTOR MUST BE ASSEMBLED IN THE CORRECT ORDER. REFER TO THE ASSEMBLY MANUAL FOR DETAILS.

NOTE: THE BATTERY MUST BE ASSEMBLED IN THE CORRECT ORDER. REFER TO THE ASSEMBLY MANUAL FOR DETAILS.

NOTE: THE TRANSMITTER MUST BE ASSEMBLED IN THE CORRECT ORDER. REFER TO THE ASSEMBLY MANUAL FOR DETAILS.

NOTE: THE RECEIVER MUST BE ASSEMBLED IN THE CORRECT ORDER. REFER TO THE ASSEMBLY MANUAL FOR DETAILS.

NOTE: THE SERVO MUST BE ASSEMBLED IN THE CORRECT ORDER. REFER TO THE ASSEMBLY MANUAL FOR DETAILS.

NOTE: THE ESC MUST BE ASSEMBLED IN THE CORRECT ORDER. REFER TO THE ASSEMBLY MANUAL FOR DETAILS.

NOTE: THE MOTOR MUST BE ASSEMBLED IN THE CORRECT ORDER. REFER TO THE ASSEMBLY MANUAL FOR DETAILS.

NOTE: THE BATTERY MUST BE ASSEMBLED IN THE CORRECT ORDER. REFER TO THE ASSEMBLY MANUAL FOR DETAILS.

NOTE: THE TRANSMITTER MUST BE ASSEMBLED IN THE CORRECT ORDER. REFER TO THE ASSEMBLY MANUAL FOR DETAILS.

NOTE: THE RECEIVER MUST BE ASSEMBLED IN THE CORRECT ORDER. REFER TO THE ASSEMBLY MANUAL FOR DETAILS.

NOTE: THE SERVO MUST BE ASSEMBLED IN THE CORRECT ORDER. REFER TO THE ASSEMBLY MANUAL FOR DETAILS.

NOTE: THE ESC MUST BE ASSEMBLED IN THE CORRECT ORDER. REFER TO THE ASSEMBLY MANUAL FOR DETAILS.

NOTE: THE MOTOR MUST BE ASSEMBLED IN THE CORRECT ORDER. REFER TO THE ASSEMBLY MANUAL FOR DETAILS.

NOTE: THE BATTERY MUST BE ASSEMBLED IN THE CORRECT ORDER. REFER TO THE ASSEMBLY MANUAL FOR DETAILS.

NOTE: THE TRANSMITTER MUST BE ASSEMBLED IN THE CORRECT ORDER. REFER TO THE ASSEMBLY MANUAL FOR DETAILS.

NOTE: THE RECEIVER MUST BE ASSEMBLED IN THE CORRECT ORDER. REFER TO THE ASSEMBLY MANUAL FOR DETAILS.

NOTE: THE SERVO MUST BE ASSEMBLED IN THE CORRECT ORDER. REFER TO THE ASSEMBLY MANUAL FOR DETAILS.

NOTE: THE ESC MUST BE ASSEMBLED IN THE CORRECT ORDER. REFER TO THE ASSEMBLY MANUAL FOR DETAILS.

NOTE: THE MOTOR MUST BE ASSEMBLED IN THE CORRECT ORDER. REFER TO THE ASSEMBLY